

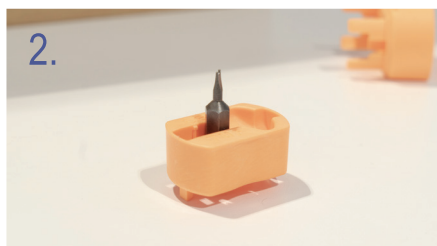

TUF Replacement tool.



Insert the 'Snake-Eye' bit into the tool as shown.



Use the tool to unscrew the two 'Snake-Eye' screws.



Lift off the TUF fascia.

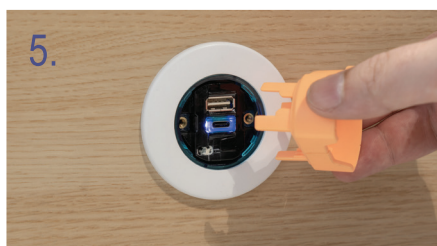

Insert the second part of the TUF Replacement tool until a click is heard (4 clips engage in TUF cartridge)



Pull the TUF cartridge out from the unit



Insert the new TUF cartridge, paying close attention to the orientation of the cartridge in the blue housing.

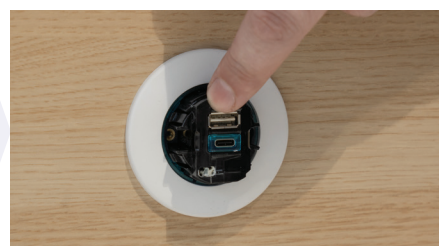

Push cartridge until a click is heard.



Place the TUF fascia back into position



Using the TUF Replacement tool and 'Snake-Eye' bit, screw the two 'Snake-Eye' screws back into place. DO NOT OVERTIGHTEN. TIGHTEN UNTIL SECURE ONLY. DO NOT USE POWER TOOLS.



CAUTION Do not overtighten 'Snake-Eye' screws. Tighten until secure only. Do not use power tools.

Additional notes

- To correctly insert the replacement TUF cartridge align the "square" and "round" side locating features with the matching features in the blue housing.
- Only a black TUF canister should be fitted in a blue housing
- Replacement TUF replacing tools can be ordered separately.

Queries / Questions / Fragen:

+44 (0) 1924 367255



<http://www.oelectrics.co.uk/tuf-replace>